

## Package leaflet: Information for the user

### **Emerade 150 micrograms, solution for injection in pre-filled pen** **Emerade 300 micrograms, solution for injection in pre-filled pen** **Emerade 500 micrograms, solution for injection in pre-filled pen**

Adrenaline

**Read all of this leaflet carefully before you start using this medicine because it contains important information for you**

- Keep this leaflet. You may need to read it again.
- If you have any further questions, ask your doctor or pharmacist.
- This medicine has been prescribed for you only. Do not pass it on to others. It may harm them, even if their signs of illness are the same as yours.
- If you get any side effects, talk to your doctor or pharmacist. This includes any possible side effects not listed in this leaflet. See section 4.

#### **What is in this leaflet:**

1. What Emerade is and what it is used for
2. What you need to know before you use Emerade
3. How to use Emerade
4. Possible side effects
5. How to store Emerade
6. Contents of the pack and other information

#### **1. What Emerade is and what it is used for**

Emerade is an auto-injector that contains adrenaline in a solution for injection.

Adrenaline counteracts the fall of blood pressure in anaphylactic reactions. It also stimulates the heart and facilitates breathing.

Emerade is used for emergency treatment of severe allergic reactions (anaphylaxis) caused by allergens in foods, medicines, insect stings or bites and other allergens. It is also used for treatment of severe reactions triggered by exercise or by unknown causes.

#### **2. What you need to know before you use Emerade**

Your doctor should have explained when and how you should use Emerade. If you are not completely sure or you have questions you must contact your doctor.

#### **Warnings and precautions**

Emerade can always be used during an allergic emergency. If you are allergic (hypersensitive) to sodium metabisulphite or to any of the other ingredients of Emerade, your doctor will need to instruct you under which circumstances Emerade should be used.

Talk to your doctor before using Emerade if you have

- heart disease,
- high blood pressure,
- an overactive thyroid,
- diabetes,
- a tumour on the adrenal gland,
- increased pressure in the eye,
- reduced kidney function,
- prostate disease,
- low potassium levels or high calcium levels in your blood.

If you have asthma you may be at increased risk of a severe allergic reaction.

Anyone who has an episode of anaphylaxis should see their doctor about testing for substances they may be allergic to, so these can be strictly avoided in future. It is important to be aware that an allergy to one substance can lead to allergies to a number of related substances. If you have food allergies it is important to check the ingredients in everything you ingest (including medicines) as even small amounts can cause severe reactions.

There is also a greater risk of getting side effects if you are elderly or pregnant.

The instructions for use must be carefully followed in order to avoid accidental injection.

Emerade should only be injected intramuscularly into the outer thigh. It should not be injected into the buttock due to the risk of accidental injection into a vein.

#### *Warnings*

Accidental injection into the hands or feet may result in reduced blood supply to these areas. If there is an accidental injection into these areas, you should go immediately to the nearest hospital emergency department for treatment.

#### *Children*

Emerade should not be used in children under 15 kg.

#### **Other medicines and Emerade**

Tell your doctor if you are using, have recently used or might use any other medicines.

This is especially important if you take any of the following:

- Antidepressants such as tricyclic antidepressants or monoamine oxidase inhibitors (MAO inhibitors), since the effects of adrenaline may be increased.
- Medicines for treatment of Parkinson's disease such as catechol-O-methyl transferase inhibitors (COMT inhibitors), since the effect of adrenaline may be increased.
- Medicines that may make the heart sensitive to uneven beats (arrhythmias), such as digitalis and quinidine.
- Medicines for heart disease or medicines to treat disorders of the nervous system called alpha and beta blocking medicines as they can reduce the effect of adrenaline.

Diabetic patients should carefully monitor their glucose levels after use of Emerade as adrenaline can increase the blood glucose level.

#### **Pregnancy and breast-feeding**

If you are pregnant or breast-feeding, think you may be pregnant or are planning to have a baby, ask your doctor for advice before taking this medicine. The experience of using adrenaline during pregnancy is limited. If you are pregnant you should however not avoid using Emerade in an emergency situation because your life can be in danger.

You can breast feed after you have used Emerade.

#### **Driving and using machines**

The ability to drive and use machines is unlikely to be affected by the administration of an adrenaline injection, but may be affected by a severe allergic reaction. If affected, do not drive.

#### **Emerade contains sodium metabisulphite**

Sodium metabisulphite may rarely cause severe allergic reactions or breathing difficulty (bronchospasm). If you are allergic (hypersensitive) to sodium metabisulphite your doctor must instruct you under which circumstances Emerade should be used.

Emerade contains less than 1 millimole sodium (23 mg) per dose, i.e. essentially sodium free.

#### **3. How to use Emerade**

Use Emerade immediately if signs or symptoms of an acute allergic reaction (anaphylaxis) begin. Reactions can arise in a few minutes after the contact with the allergen and the symptoms can be, for example, rash, flush or swelling. More severe reactions also affect blood circulation and breathing.

Always use Emerade exactly as your doctor has told you. You should check with your doctor or pharmacist if you are not sure.

Before you need to use Emerade, make sure you understand in what situations you should use Emerade. It is important that you always carry Emerade with you if you are at risk of anaphylaxis. You should store Emerade in the original package, a specially designed case to protect the pen and the label showing how to use the pen in an emergency situation. Always keep this information leaflet in the case.

#### **Dosage**

The dose will be decided by your doctor depending on your bodyweight.

Adolescents and adults: The recommended dose is 300 to 500 micrograms.

#### **Use in children**

Children between 15 kg and 30 kg in weight:

The usual dose is 150 micrograms. The dose will need to be increased as your child develops and will need to be discussed with your doctor.

A dosage below 150 micrograms cannot be administered with sufficient accuracy in children weighing less than 15 kg and use is therefore not recommended unless during a life-threatening situation and under medical advice.

Children and adolescents over 30 kg in weight should be prescribed an Emerade 300 micrograms.

Emerade 500 micrograms is not recommended for use in children.

#### How Emerade is given

The instructions for use must be carefully followed in order to avoid accidental injection.

Emerade should only be used for injection in the outer thigh. The injection occurs when Emerade is pressed into the thigh. It can be administered through clothing. It should not be injected into the buttock (your bottom).

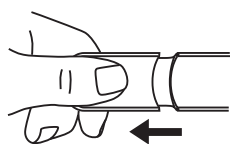

1. Remove the needle shield.



2. Place and press Emerade against the outer side of the thigh. You will hear a click when the injection goes into the muscle.



3. Hold Emerade against the thigh for about 5 seconds. Lightly massage the injection site afterwards.  
**Seek immediate medical help.**

The needle in Emerade is protected before, during and after the injection.

When the injection is completed, the plunger is visible in the inspection window by lifting the label.

In some cases one dose of adrenaline is not enough for the relief of a severe anaphylactic reaction. Your doctor can therefore recommend that you take a second dose after 5 to 15 minutes with an additional Emerade. You are therefore recommended to always have more than one Emerade with you.

Emerade is designed as emergency treatment. You should always get medical help immediately after using Emerade. Dial 999 and ask for an ambulance. State **'anaphylaxis' even if symptoms appear to be improving.** You will need to go to hospital for observation and further treatment as required. This is because the reaction may happen again at some time later. Take the used auto-injector with you.

While waiting for the ambulance you should lie down with your feet raised unless this makes you breathless in which case you should sit up. Ask someone to stay with you until the ambulance arrives in case you feel unwell again.

Unconscious patients should be placed on their side in the recovery position.

**Do not remove the needle shield unless injection is required.**

Some liquid remains in the auto-injector after the injection. The auto-injector cannot be re-used.

#### If you use more Emerade than you should

If you have taken a too large dose, or if you have accidentally injected Emerade into a blood vessel or into a hand, you must **immediately** seek medical help. Your blood pressure may rise sharply. Overdose may cause a sudden increase in blood pressure, irregular heartbeat and accumulation of fluid in the lungs which can make it difficult to breathe.

If you have any further questions on the use of this product, ask your doctor or pharmacist.

#### 4. Possible side effects

Like all medicines, this medicine can cause side effects, although not everybody gets them.

The following side effects are based upon experience with the use of adrenaline but the frequency of side effects cannot be estimated:

- heart problems such as irregular and rapid heartbeat, chest pain,
- high blood pressure, narrowing of the blood vessels,
- sweating,
- nausea, vomiting,
- difficulty breathing,
- headache, dizziness,
- weakness, shaking,
- anxiety, hallucinations,
- fainting,
- changes in your blood values such as increased blood sugar, decreased potassium and increased acid.

#### Reporting of side effects

If you get any side effects, talk to your doctor or pharmacist. This includes any possible side effects not listed in this leaflet. You can also report side effects directly via the Yellow Card Scheme at: [www.mhra.gov.uk/yellowcard](http://www.mhra.gov.uk/yellowcard)

By reporting side effects you can help provide more information on the safety of this medicine.

#### 5. How to store Emerade

Keep this medicine out of the sight and reach of children. Do not freeze.

Do not use this medicine after the expiry date which is stated on the label. The expiry date refers to the last day of that month. Discard and replace Emerade after the expiry date. The solution can be examined through the inspection window at any time. Discard and replace Emerade if the solution is discoloured or contains precipitate.

Inspect the auto-injector if dropped. Replace if you notice damage or leakage.

Do not throw away any medicines via wastewater or household waste. Ask your pharmacist how to throw away medicines you no longer use. These measures will help to protect the environment.

#### 6. Contents of the pack and other information

##### What Emerade contains

The active substance is adrenaline as tartrate. Emerade 150 micrograms delivers 150 micrograms of adrenaline in 0.15 ml of solution. Emerade 300 micrograms delivers 300 micrograms of adrenaline in 0.3 ml of solution. Emerade 500 micrograms delivers 500 micrograms of adrenaline in 0.5 ml of solution.

The other ingredients are: sodium chloride, sodium metabisulphite (E223), disodium edetate, hydrochloric acid and water for injection.

##### What Emerade looks like and content of the pack

Emerade is an auto-injector that delivers one single dose of adrenaline.

Emerade is a clear and colourless solution for injection inside a glass syringe. Emerade is latex free.

The device is a white cylinder in which a needle shield covers the needle and the triggering mechanism.

Pack sizes: 1 or 2 pre-filled pens.

All pack sizes may not be marketed.

##### Marketing Authorisation Holder and Manufacturer

###### Marketing Authorisation Holder

PharmaSwiss Česká republika s.r.o.  
Jankovcova 1569/2c, 170 00 Prague 7, Czech Republic

###### Manufacturer

Rechon Life Science AB  
Soldattorpsvägen 5, SE-216 13 Limhamn, Sweden

**This leaflet was last revised in September 2014**